

## Ricoh Paper Tray Repair Kit Instructions

**NATT #:** 02042004

**For use in:**

AF MPC2030/ AF MPC2050/ AF MPC2051/ AF MPC2530/ AF MPC2550/ AF MPC2551/ C9020/ C9025  
C9120/ C9125/ LD520C/ LD525C/ LD620C/ LD625C/ MPC2030/ MPC2050/ MPC2051/ MPC2550/ MPC2551

**Caution:** Read all instructions first, as removing an improperly installed bracket will be very difficult.

1. Identify broken area on paper tray and confirm lever shaft spring location (may have fallen off tray.)
2. Do not remove double sided tape liner from bracket yet.
3. Using a knife or dikes cutter, remove only enough plastic material from broken tray frame to allow repair bracket to slide completely to bottom of pocket. (Photo A and B)
4. Before peeling tape liner, confirm operation of assembly with special attention given to fully seating the bracket with no interference from plastic to new pivot pin. (Photo C)
5. After confirming fit and function of assembly, remove tape liner, reinsert pivot pin into socket on lever shaft, and slide bracket fully into pocket.
6. After again confirming operation, drive the self-tapping screw thru hole in bracket and into plastic frame using a 1/4 inch bit holder. Do not over tighten. (Photo D and E)

**Kit Contains:**

1. Self-tapping Screw
2. Repair Bracket with Adhesive
3. Instruction Sheet

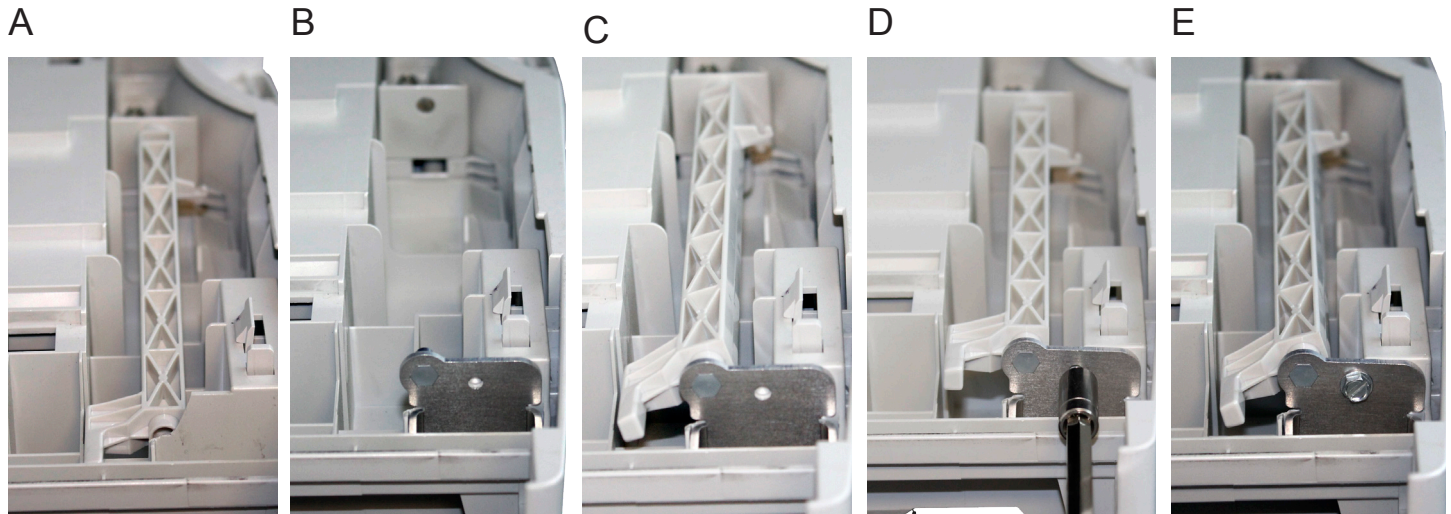
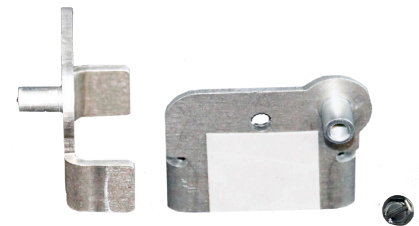

**Optional:** 1/4 inch Bit Holder  
with Soft Panel Grip  
**NATT#:** 00013017  
\*Sold separately



To learn more about **NA Trading** and our complete **Ricoh** product line, contact a product specialist or visit us online today.

**800 231 8434** | [www.natrading.com](http://www.natrading.com)