

Ricoh* Finisher door tab repair

OEM: D3CH6125 (Finisher door for SR4120, SR4130, SR4090 and SR4100)

NATT: 02042010

MODELS: MPC6502, MPC6503, MPC8003, MPC3004, MPC3504, MPC4504, MPC6004, MPC3004ex, MPC4504ex, MPC6004ex, MP6503, MP7503, MP9003



PROBLEM: The OEM used flimsy plastic for the photointerrupter tab on the D3CH6125 finisher door. The tab is prone to breaking, and it's a photointerrupter, so when it breaks the whole machine goes down until the door is replaced. Unless you have our repair item.

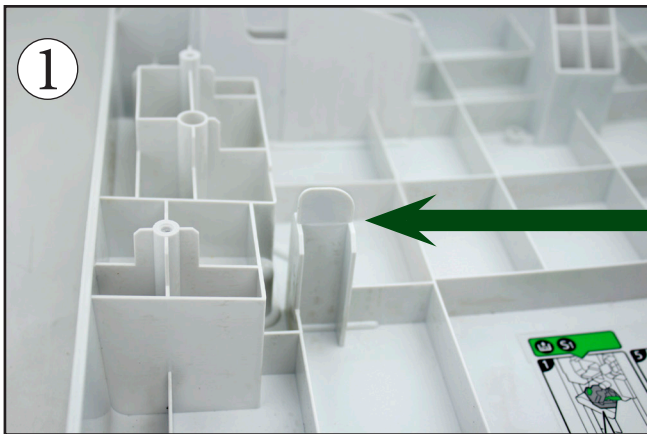

SOLUTION: Installing this stabilizing bracket by affixing it to the panel with high-bond adhesive is quick and easy, and it will prevent downtime and an unnecessary service call at a cost significantly lower than the price of a new panel.

INSTALLATION INSTRUCTIONS

ORIENTATION: When the door is removed and in the upright position with the interior facing the installer, the broken tab will be on the left near the bottom. The repair affixes to the right side of the broken tab.

PREPARATION: Observe the surface of the broken tab. Use a Chicopee shop towel and isopropyl alcohol to wipe away dust or grime that has accumulated.

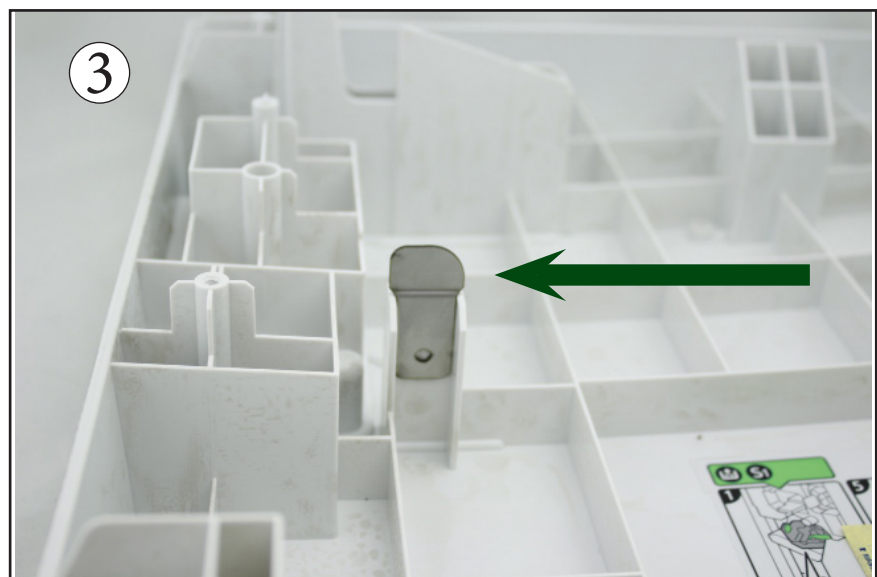

INSTALLATION: Peel back the plastic to expose the high-bond adhesive, then press the bracket firmly against what remains of the broken tab. The more gradually curved edge should face upward so the repair is flush with the broken tab (see image 3). After a moment, when the bond is secure, reinstall the finisher door.